

OPERATING INSTRUCTIONS

MODEL DS1522 DOUBLE SHEET DETECTOR

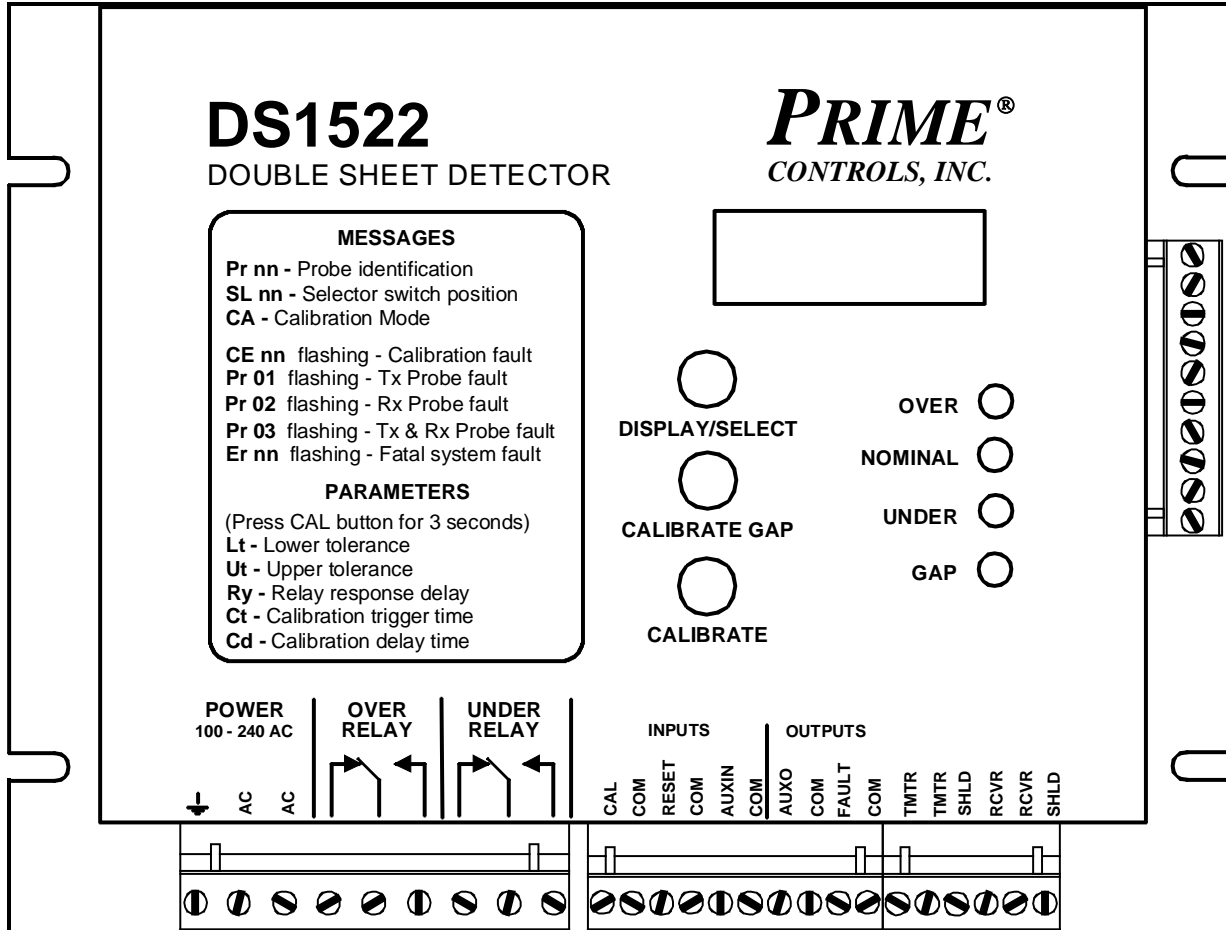

DESCRIPTION

The Model DS1522 Double Metal Sheet Detector comprises a control module in a sheet metal housing with two probes to form a system that detects the thickness of metals passing between the probes. The thickness is reported via two form C relays as “nominal”, “over”, “under” or “nothing”. The DS1522 is capable of retaining up to 64 preset calibration setups which can be invoked locally or remotely. This system may be used on automatic sheet feeders where double or overlapped sheet material may jam or damage the receiving machine or ahead of roll forming equipment to insure lap welds do not damage the equipment. A double feed or overlap produces an output to stop the machine or signal the operator.

DESCRIPTION

System Features

The DS1522 is a highly flexible gauging system with a variety of features, some of which may be enabled or disabled through the positioning of DIP switches located beneath the control module cover. The various features include:

- Accommodates a family of probes allowing double detection on metals, from foil to heavy plate.
- Manual calibration on single and double thickness for all metals.
- Manual calibration on single thickness for steel.
- Automatic calibration on steel after material absence for a preset trigger time.
- Automatic calibration after lap welds of steel coil stock (Firmware Version 2.21 and up).
- Automatic nominal adjustment for roll stock of varying thickness.
- Independent over and under tolerance adjustment in 1 percent increments.
- Optional multiple calibration presets (up to 64).
- Local or remote selection of preset memories.

Each of these features is described in greater detail later in this document.

Control Module

The features of the control module include:

- Universal power input accommodates AC voltages from 100 to 240 volts.
- Removable terminal blocks for quick change-out of the control module.
- Separate form C relay outputs for independent reporting of OVER and UNDER conditions.
- LED indicators report the current gage states of NOTHING, UNDER, NOMINAL, and OVER.
- Automatic setup of system gain and operating parameters.
- External or front panel calibration through a contact closure or the front panel push-button switch.
- Sixty four calibration memories that are selected through the DISPLAY/SELECT pushbutton or optionally through an external parallel connection to a PLC or selector switch. These memories allow quick changeover between materials of different nominal thickness. The memory contents are retained even when power is removed from the unit.
- Latching OVER and UNDER outputs that are cleared by asserting the RESET input.
- Fast, NPN open collector logic AUXO output that is ON for nominal readings and OFF for OVER or UNDER.
- NPN open collector FAULT output that may be connected to a master controller for monitoring fault and gauge-not-active conditions.
- Probe fault reporting on the digital display warns of broken or disconnected probes or cables.

Control Module Indicators

The function of the indicators and display on the DS1522 control module are described in the following paragraphs:

1. OVER LED is ON whenever the material thickness exceeds the calibrated nominal value by more than the set tolerance.
2. NOMINAL LED is ON whenever the received signal is within the specified tolerances, both over and under.
3. UNDER LED is ON whenever there is material between the probes but the material thinner than the calibrated nominal value by more than the set tolerance.
4. NOTHING LED is ON whenever the received signal goes beyond the measuring range of the instrument indicating an absence of material between the probes.
5. The OVER, NOMINAL, UNDER, and NOTHING LEDs flash in succession when the system is in calibrate mode.
6. Numeric Display indicates the level of the signal from the receiving probe and reports error or status conditions. During gauge operation the value on the display reflects the strength of the signal from the receiving probe. Thicker materials reduce the level of the signal reaching the receiving probe, consequently the displayed value is lower for thicker material and higher for thinner material.

Control Module DISPLAY/SELECT Pushbutton

Through the DISPLAY/SELECT pushbutton you can display the current local (**Lc**) preset memory address if the DS1522 is off-line, i.e. the external enable signal is not asserted, or you can display the current remote (**rE**) preset memory address if the GPIO signal is asserted. Thus it is possible to determine if the unit is off-line or on-line by pressing the DISPLAY/SELECT pushbutton and noting the identifier that displays. As long as the pushbutton is held, the identifier displays. When the pushbutton is released, the currently selected preset address displays for 5 seconds. The local address cannot be displayed if the DS1522 is on-line, i.e. the external enable signal on the GPIO pin is asserted.

The local and remote addresses are independent values but they point to the same calibration memories. When the external enable signal is asserted on the GPIO pin of the external select port, the DS1522 is on-line and the remote address as applied to terminals IN1 through IN5 is applied. The local address may not be displayed and changed while the DS1522 is on-line. Conversely, the remote address may not be displayed while the DS1522 is off-line.

The local address can be changed by tapping the pushbutton while the value is displayed; the remote address cannot. The remote address is determined by the signals entering the port at the right of the control unit and cannot be changed locally. The local and remote addresses display as a simple two digit number.

When the DISPLAY/SELECT pushbutton has been in the released state for 5 seconds, the display reverts back to displaying gauge information.

Control Module CALIBRATE GAP Pushbutton

The CALIBRATE GAP pushbutton initiates the gap calibration process. With no material between the probes, press and hold the pushbutton for a minimum of three seconds to initiate

DESCRIPTION

gap calibration. The system responds by displaying alternately **gAP** and **SU** until the calibration process is complete. Calibration of the gap needs to be done once whenever the probes are changed or the physical spacing of the probes changes.

Control Module CALIBRATE Pushbutton

The CALIBRATE push-button switch on the front panel of the control module serves to initiate the calibration process and to make adjustments to several numeric parameters including the upper tolerance (**Ut**), the lower tolerance (**Lt**), the automatic calibration trigger time (**Ct**), the calibration delay time (**Cd**), and the relay delays (**ry**).

To initiate calibration, simply press the pushbutton and release it within 3 seconds.

To view the current value of a parameter, press the pushbutton and hold it for more than 3 seconds until the appropriate parameter identifier appears on the digital display. After the parameter identifier appears, release the pushbutton and the current value of the parameter displays for 5 seconds. To retain the current value of the parameter, simply allow the 5 second display interval to elapse. The display reverts back to displaying signal strength.

To change the value of a parameter, press the pushbutton and hold it for more than 3 seconds until the appropriate parameter identifier appears on the digital display. After the parameter identifier appears, release the pushbutton and the current value of the parameter displays. Press the pushbutton while the parameter is displaying and the value increments, first slowly then more rapidly. For more precise control of the value adjustment, simply tap the pushbutton repeatedly until the desired value is displayed. All parameters roll back to their minimum values after reaching the maximum value. To retain the adjusted value of the parameter, simply allow the 5 second display interval to elapse. The display reverts back to displaying signal strength.

DESCRIPTION

Control Module Configuration Switches

An eight position DIP switch is located beneath the front cover on the main control circuit board to the left of the displays. These switches must be set to enable the features of the system that are appropriate to your application. Any time a switch setting is changed, the control module must be powered down and back up to install the change. The switches are read only at power up.

The functions of the switches are as follows:

Switch 1:	OFF	Disable automatic calibrate after double detection.
	ON	Enable automatic calibration after double detection (Version 2.1 and up)
Switch 2:	OFF	Automatic frequency selection during calibration.
	ON	Manual frequency selection (two-hit calibration only).
Switch 3:	OFF	Calibrate on single and double.
	ON	Calibrate on single only.
Switch 4:	OFF	Disable reference tracking.
	ON	Enable reference tracking.
Switch 5:	OFF	Slow memory changeover with address display
	ON	Rapid memory changeover, no address display (Version 1.7 and later)
Switch 6:	OFF	Disable automatic calibration trigger after material void.
	ON	Enable automatic calibration trigger after material void.
Switch 7:	OFF	Control interprets external selector port signals as high when activated.
	ON	Control interprets external selector port signals as low when activated.
Switch 8:	OFF:	The state of the relays and AUX0 for NOTHING in the gap is the same as for the NOMINAL state.
	ON:	The state of the relays for NOTHING in the gap, is OVER for the OVER relay and UNDER for the under relay and the state of AUX0 is not nominal.

Control Module Polarity Jumpers

Each of the logic inputs (CAL, RESET, and AUXIN) to the DS1522 has associated with it a two position jumper plug located under the front cover and immediately behind its associated connector. These jumpers allow the inputs to be driven by a sinking or sourcing device. When the jumper plug is installed on the pins closest to the connector, the input is set up for a sourcing driver. When installed on the two pins farthest from the connector, the input is set up for a sinking driver, or dry contact between the input and COM.

Whether set for sinking or sourcing drivers, the input is active (ON) when the signal at the terminal is low (at COM).

APPLICATION CONSIDERATIONS

Choice of Probes

The DS1522 accommodates a number of Prime probes but is most often used with the P1000B, P70A, and P70CS probes. The P70A and P1000B probes are potted and completely sealed units with permanently attached cables. The P70CS probes are potted with connectors for easy removal. The same probe type is used for transmitter and receiver and is not polarized.

The table below provides rule of thumb information for probe selection.

Probe	Housing	Connection	Gap	Application
P1000B	Aluminum block	Cable	0.5" to 1.25"	0.060 and thicker
P70A	Threaded steel barrel	Cable	0.5" to 0.75"	0.004 to 0.060 steel
P70CS	Smooth stainless barrel	Connector	0.5" to 3.00"	0.004 to 0.060 steel

Probes with non-ferrous (aluminum and stainless steel) housings offer greater probe separation. Probes with steel housings are not affected by the material used for mounting. Probes with aluminum or stainless steel housings are affected by steel near them including mounting clamps. To realize maximum separation with the P70CS type units, the probes must be mounted in non-ferrous clamps, e.g. Nylatron or 303 stainless steel.

Prime offers a number of other probes that allow the DS1522 to be applied to a wide range of materials including magnesium, copper, stainless steel, and aluminum. For more information or assistance in selecting the appropriate probes, contact Prime Controls.

Calibration Considerations

The DS1522 offers four different modes of calibration.

1. Manual calibration on single and double thickness material (two-hit calibration). In this mode, a sample of the nominal thickness is placed between the probes and the CAL pushbutton or optional external cal switch is pressed. Then a second thickness (or multiples of the original) are placed between the probes and the CALIBRATE pushbutton or external cal switch is again pressed. Calibration is complete unless the tolerance value must be adjusted.
2. Manual calibration on single thickness steel (single-hit calibration). In this mode, calibration can be initiated through a press of the CALIBRATE pushbutton or an optional external cal switch prior to material entering the gap between the probes. The DS1522 enters a wait state until material is fed between the probes. If the calibration delay parameter (**Cd**) is set to zero, calibration occurs within 100 milliseconds after material is sensed between the probes. For slow moving material, this delay can be increased (up to 9.9 seconds) to insure the material fully covers the probes before calibration occurs. See the **Control Module CALIBRATE Pushbutton** section earlier in this document for the parameter adjustment procedure.

APPLICATION CONSIDERATIONS

3. Automatic calibration on single thickness steel after coil change (Switch 6 ON). In this mode, calibration process is the same as for the manual single-hit calibration except that the calibration process can be initiated by the expiration of a timer within the DS1522. The timer can be set to a value from 0.1 minute (6 seconds) to 25 minutes. When the DS1522 detects the absence of material between the probes, the timer count-down begins. If the count-down expires before material is sensed, the DS1522 enters calibration mode, waiting for material to be fed. If the calibration delay parameter (**Cd**) is set to zero, calibration occurs within 100 milliseconds after material is sensed between the probes. For slow moving material, this delay can be increased (up to 9.9 seconds) to insure the material fully covers the probes before calibration occurs. See the **Control Module Calibrate Pushbutton** section earlier in this document for the parameter adjustment procedure.
4. Automatic calibration on single thickness steel after double (overlap) detected (Switch 1 ON). In this mode, available in systems with Firmware Version 2.1 and higher, the calibration process is the same as for modes 2 and 3 above except that the calibration process is initiated by the occurrence of a lap weld or overlap in the incoming material. When the OVER condition is detected, the OVER relay switches for a minimum of 25 milliseconds and then after the programmed calibration delay (**Cd**) calibration commences. The intent of this mode is to detect lap joints and provide automatic recalibration on the material following the lap joint.

When automatic calibration after double is enabled (Switch 1 ON), the calibration delay (**Cd**) parameter may be used to insure calibration occurs beyond the overlap area. However, should calibration occur on the overlap, the detection of an under condition after the overlap will initiate recalibration if the under tolerance is set appropriately. The delay of relay response through the “**ry**” parameter may still be used in this mode. However for detection of short overlaps it may be necessary to set the relay delay to zero for fastest gauge response.

The choice of calibration mode is application dependent since each mode has its advantages and disadvantages. Two-hit calibration offers the possibility of discriminating changes in metal thickness that are far less than 2 to 1 since the system is calibrated on samples of the thickness range to be discriminated.

Relay Response Time

For most applications it is desirable that the OVER relay respond as quickly as possible. For thinner materials the response time is as fast as 3 milliseconds. For very thick metals the response time can be as long as 40 milliseconds.

If very fast response times are undesirable, the action of the relays can be delayed through the adjustment of the relay delay parameter (**ry**). This parameter represents a time interval in fractions of a second from .00 to .99 seconds. To adjust the delay value, press and hold the CAL pushbutton until the identifier “**ry**” appears on the two digit display. Release the pushbutton and observe the current value of the delay parameter. Press and/or tap the CAL pushbutton as necessary to bring the delay parameter to the desired value. To retain the adjusted value of the parameter, simply allow the 5 second display interval to elapse. The display reverts back to

displaying signal strength. See the **Control Module Calibrate Pushbutton** section earlier in this document for the parameter adjustment procedure.

Tracking Nominal

The tracking nominal feature of the DS1522 (Switch 4 ON) is typically used on roll-fed material that varies in thickness over its length. The unit keeps a slow average of the thickness and gauges relative to the average rather than relative to a fixed nominal calibration value. The average is referred to as the tracking nominal. The tracking nominal is allowed to shift by as much as 50% in thickness in either direction from the calibrated nominal.

Whenever no material is sensed between the probes, the calibrated nominal is reinstated regardless of the final thickness of the previous material.

Gauge and Fault Monitoring

The open collector FAULT output provides a means for monitoring the status of the DS1522 to insure that all material passing between the probes is checked for doubles. When the DS1522 controller detects a probe fault or a fault within the controller itself, the FAULT output turns OFF. Since OFF is the fault state, a loss of power to the DS1522 is reported as a fault.

The FAULT output also turns off whenever the controller is not in gauge mode, i.e. whenever the unit is in setup (**SU**) or calibration (**CA**) mode.

INSTALLATION

The installation of the components of the DS1522 system is covered in the following paragraphs:

DS1522 Control Module

The control board is designed to mount on the back panel of an electrical enclosure using the four mounting slots at the edges of the enclosure. The footprint is 8.25 inches (210 mm) by 6.25 inches (159 mm) with mounting slot locations on a rectangle 7.625 inches (194 mm) in the horizontal and 4.0 inches (102 mm) in the vertical. Insure that the mounting screws make good electrical contact between the module housing and the control enclosure back panel.

Avoid mounting locations with excessive heat and vibration.

Probe Mounting

See instructions specific to the probes supplied with your system.

Electrical Wiring

All wiring for the DS1522 connects to removable terminal blocks at the bottom of the control enclosure as described in the following paragraphs.

1. Connect 100 to 240 VAC, 50-60 Hz. power (15 watts) to the terminals labeled AC on the leftmost terminal block.
2. Connections to the control circuit of the machine are made through the OVER and UNDER form C relays as required. These relays are powered in the NOMINAL condition and the diagram on the DS1522 front panel reflects the NOMINAL state. As shipped from the factory, the NOTHING state places the relays in the same state as NOMINAL. DIP switch 8, beneath the cover of the DS1522, when ON, causes the NOTHING condition to place the OVER and UNDER relays in the over and under states simultaneously.

Dips Switch 8 Off				
Condition	Output Relay State			
	Over Relay		Under Relay	
	N.C.	N.O.	N.C.	N.O.
Nothing	Closed	Open	Closed	Open
Under	Closed	Open	Open	Closed
Nominal	Closed	Open	Closed	Open
Over	Open	Closed	Closed	Open

Dips Switch 8 On				
Condition	Output Relay State			
	Over Relay		Under Relay	
	N.C.	N.O.	N.C.	N.O.
Nothing	Open	Closed	Open	Closed
Under	Closed	Open	Open	Closed
Nominal	Closed	Open	Closed	Open
Over	Open	Closed	Closed	Open

INSTALLATION

3. The shielded cables from the probes to the board should be run in conduit. The receiver probe is connected to terminals labeled RCVR on the rightmost terminal block and the transmitter probe to the terminals labeled TMTR on the same terminal block. Since the probes are non-polarized, the order of lead connection is not important and since the probes are identical, it does not matter which is the transmitter and which is the receiver. Connect the shield leads (drain wires) from the probe cables to the terminals labeled SHLD.
4. The OVER and UNDER relays may be operated in a "follower" mode or a "memory" mode depending upon the wiring of the RESET input. The operational modes and required connections are described below.
 - a) For "follower" mode, jumper RESET and COM together on the center terminal block. In this mode, when an OVER or UNDER condition occurs, the appropriate relay drops out, and the OVER or UNDER LED comes on. After the fault condition is corrected, the relay returns to the normally energized condition and the LED goes out. Automatic reset is normally selected to control the operation when the fault condition is automatically removed or the DS1522 is wired into the stop circuit of the machine.
 - b) For "latch" mode, wire the RESET and its associated COM terminal to the normally open contacts of a switch, relay, or controller output. In this mode, when a fault condition occurs, the relay drops out and the OVER or UNDER LED comes on. After the fault condition is corrected, the contact must be momentarily closed to energize the relay. Note: If Dip Switch 8 is On, Reset Input will have to be asserted after a Nothing condition is present at the probes as well.
5. Optionally, the NPN open collector FAULT output may be connected to a master system controller or to an indicator that warns of an error condition within the DS1522 system. This output is normally ON and turns OFF when an error condition is detected. Thus if the DS1522 loses power, the FAULT output reports an error condition by default.

The FAULT output turns OFF any time the DS1522 is not gauging the metal between the probes. In addition to error conditions, setup (**SU** on the display) and calibration (**CA** on the display) cause the fault output to turn OFF. This allows the unit to be monitored for non-gauge conditions.

6. Another Option is the NPN open collector AUXO output may be connected to a master system controller. This sinking output turns on to provides an indication of a Nominal reading versus a Under or Over reading (output). Like the Output Relays, the position of Dip Switch 8 effects whether a Nothing condition is indicated differently from a Nominal condition.

Condition	AUXO Ouput State	
	Dip Switch 8 Off	Dip Switch 8 On
Nothing	On (sinking)	Off
Under	Off	Off
Nominal	On (sinking)	On (sinking)
Over	Off	Off

Optional Remote Preset Calibration Selection

The 10 terminal connector at the right side of the DS1522 chassis provides a means to control the selection of calibration presets from an external switch or remote controller such as a PLC (See illustrations on following page). The rightmost terminals labeled IN6 through IN1 accept signals in binary combination to select preset memories numbered from 0 through 63. IN1 is the least significant bit. Thus the addresses are formed as follows:

IN6	IN5	IN4	IN3	IN2	IN1	ADDRESS
off	off	off	off	off	off	00
off	off	off	off	off	on	01
off	off	off	off	on	off	02
-						
-						
on	on	on	on	on	off	62
on	on	on	on	on	on	63

The GPIO terminal (4th from the bottom) is the “enable” signal. When asserted, this signal tells the control module to use the address applied to terminals IN1 through IN6 for preset calibration selection. When enable is not asserted, the control module uses the local address as programmed through the DISPLAY/SELECT pushbutton for preset calibration selection. See the section on **Control Module DISPLAY/SELECT Pushbutton** earlier in this document.

These inputs may be set to accommodate either sinking (open collector) or sourcing (PNP) drivers. All inputs are set to the same mode; mixed modes are not allowed. A two position jumper plug in the upper right corner of the I/O board (accessible from the top when the cover is removed) connects the inputs through 4700 ohm resistors to +15 volts when in the left position (center and left pin connected), or to ground (COM) when in the right position (center and right pin connected). Typically the jumper is placed in the left position for sinking drivers and in the right position for sourcing drivers.

Additionally, DIP switch 7 (seventh from the top) tells the control module if the inputs are active when high (Switch 7 OFF – to the left) or active when low (Switch 7 ON – to the right). Typically Switch 7 is OFF for sourcing drivers and ON for sinking drivers.

INSTALLATION

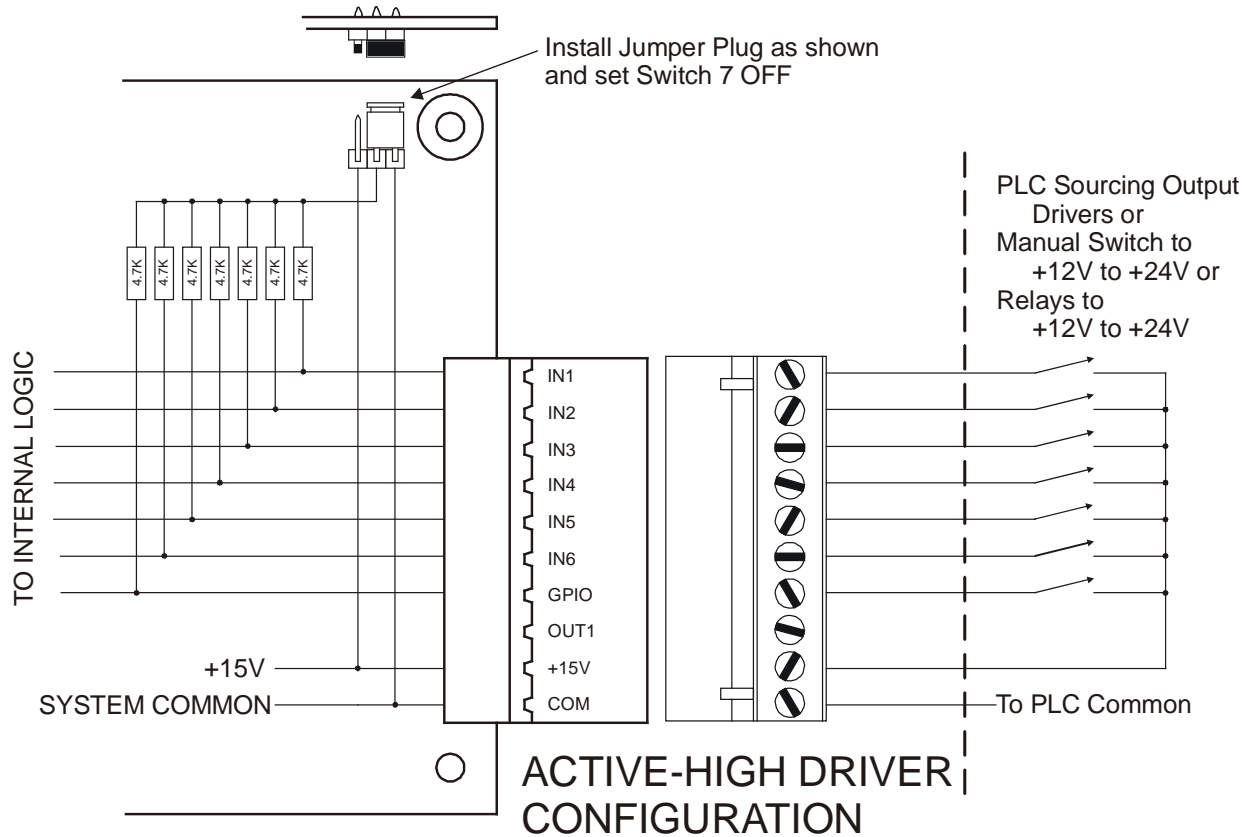
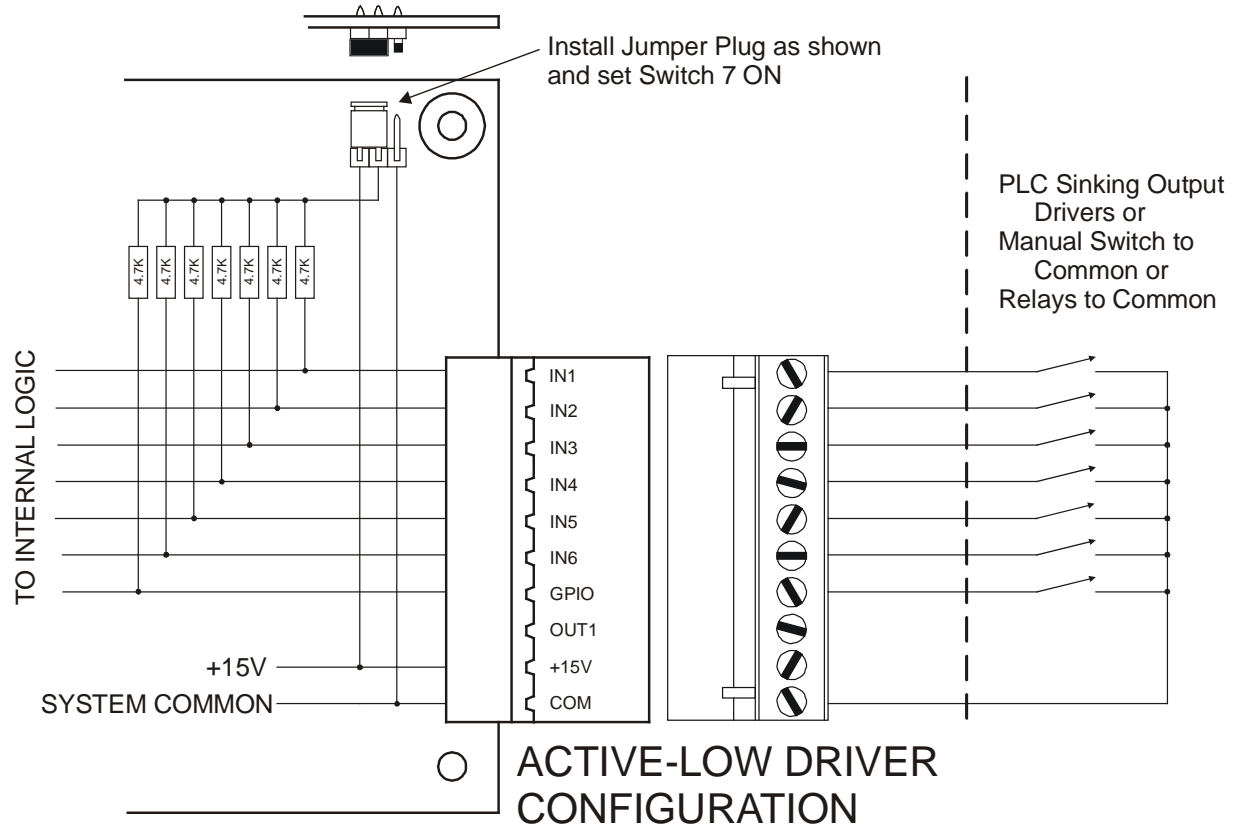

INITIAL SETUP

Probe and Gap Assessment

The startup process of the DS1522 commences immediately after power up and includes several processes which are transparent to the user except for the sequence of characters that appear on the two digit display.

When the unit first powers up, the probes are analyzed to determine the type of probe attached to the control unit. While the assessment is in process, the letters **Pr** flash on and off. When the type of probe has been established, the probe identifier flashes alternately with **Pr** for approximately 3 seconds. The probe identifiers include **15**, **70**, and **1H**. After identifying the probes, the control module determines which calibration preset is to be used and then displays alternately **SL** and the preset number, e.g. **SL 01**. If the probes are faulty, disconnected, or cannot be identified, the controller flashes **PR 01** indefinitely.

After the probes have been identified and the calibration memory selected and displayed, the control module begins displaying the signal strength from the receiving probe. If the system has been newly installed or the relative positions of the probes has been changed, it is necessary to “calibrate the gap”. With no material between the probes, press and hold the CALIBRATE GAP pushbutton for three seconds until the letters **SU** and **gAP** flash alternately on the display. The system records the “no material condition” in non-volatile memory. When the display reverts to displaying signal strength, the gap calibration process is complete. *It is essential that for this assessment there is no material between the probes.*

When the operating conditions have been established, the two digit readout displays a numeric value representing the receiver signal strength.

Gauge Tolerance Adjustment

When the startup sequence has been completed and if the probes are successfully identified, the system enters gauge mode and displays the receiver signal strength on the two digit display. At this point the gauging tolerances should be verified and/or set as described below: If more than one calibration memory is to be used, the tolerances must be adjusted independently for each stored calibration. The tolerance adjustments may be done any time except when the system is in calibration mode (displaying “**CA**”).

1. Press and hold the calibration pushbutton for 3 seconds or until the unit displays “**Ut**” (**Upper tolerance**). Release the pushbutton and observe the setting for the upper tolerance value. The tolerance displays as a percentage of the single thickness and can be adjusted from a value of 1 to 99. If the pushbutton is not pressed again within 5 seconds, the display reverts back to displaying gauge signal strength and the current upper tolerance value is retained. To change the upper tolerance, tap or hold in the pushbutton as necessary to adjust the upper tolerance to the desired value. For detection of doubles, 50% is a good value. Retain and store the displayed value by releasing and not activating the pushbutton for 5 seconds. The display reverts back to showing signal strength.
2. Press and hold the calibration pushbutton for 4.5 seconds or until the unit displays “**Lt**” (**Lower tolerance**). Release the pushbutton and observe the setting for the lower tolerance value. The tolerance displays as a percentage of the single thickness and can be adjusted from a value of 1 to 99. Tap the pushbutton as necessary to adjust the lower tolerance to the desired value. If gauging for “under” is of no interest, set the lower tolerance to a high value such as 99%. Retain the displayed value by releasing and not activating the pushbutton for 5 seconds. The display reverts back to showing signal strength.

Relay Response Time

Check that the relay response time is appropriate for your application. The relay delay parameter current value can be viewed by pressing and holding the CAL pushbutton until the “**ry**” identifier appears on the two digit display. Release the pushbutton and observe the current value of the delay parameter. Press and/or tap the CAL pushbutton as necessary to bring the delay parameter to the desired value. To retain the adjusted value of the parameter, simply allow the 5 second display interval to elapse. The display reverts back to displaying signal strength.

The delay value displays in seconds and can be adjusted from zero (.00) to .99 seconds.

CALIBRATION

The DS1522 offers three modes of calibration: 1) manual calibration on single and double material samples, 2) manual calibration on a single thickness material sample, and 3) automatic calibration on material coming between the probes after a period of no material between the probes.

Calibration on Single and Double Thickness

For highest gauging precision, the double sheet detector must be calibrated on both a single and a double thickness of the material to be monitored, any time prior to running. This mode of calibration is selected when Switch 3 is OFF. Calibration values are retained even when power is removed from the DS1522. Depending upon selected options, the system can retain one, two, or up to 64 different calibration settings in non-volatile memory. See the separate section on **Multiple Calibration Memories**. To calibrate on single and double, proceed as follows:

1. Place a single sheet of the thickness to be gauged in the probe gap and press the CAL pushbutton or close a contact across the external CAL input. If the calibration on single is accepted, the unit displays alternately "CA" and "2" indicating readiness to calibrate on a double thickness. If the calibration is not successful, the unit displays alternately "CE" and a number. Calibration may be attempted again immediately.
2. Place a double thickness of material to be gauged in the probe gap and press the CAL pushbutton or close a contact across the external CAL input. If the calibration is successful, the unit resumes display of the signal strength. If the calibration is not successful, the unit displays alternately "CE" and a number. If this occurs, reinsert the single thickness and begin calibration again.
3. Adjust the gauge tolerance values if necessary (See Gauge Tolerance Adjustment under INITIAL SETUP) and proceed with normal operation.

Manual Calibration on Single Thickness

Manual calibration on single thickness is selected when Switch 3 is ON and Switch 6 is OFF. If you change the switch settings, be sure to power the unit down and back up to activate the new settings. The switches are read only at power-up.

When calibrate-on-single is selected, the calibration process may be triggered in two ways: by the press of the front panel pushbutton, or by a 30 millisecond or longer contact closure between the external CAL input and COM.

Place a single sheet of the material to be gauged in the probe gap and press the CAL pushbutton or close a contact across the external CAL input. If the calibration-on-single is accepted, the unit displays alternately "Fr" and a number indicating the frequency selected for operation. The displayed number has no meaning except for factory troubleshooting.

If the control senses no material between the probes when the CAL pushbutton is pressed or the external CAL input is activated, it enters a wait state, flashing "CA" on the display until material is brought between the probes. An additional calibration delay can optionally be introduced through the calibration delay parameter (Cd). If not zero, this delay holds off the calibration process for the specified delay time after material comes between the probes to insure the material fully covers the probes during calibration. The additional delay may be

CALIBRATION

required with slow-moving material. See the **Calibration Delay Time** section later in this document for the parameter adjustment procedure.

Gauging commences immediately after calibration but only if the pushbutton is released and the contact across CAL and COM is released. If either of the calibration initiating signals persists, the unit hangs in a wait state.

Automatic Calibration on Single Thickness

Two switches must be properly set to enable automatic calibration. The system must be enabled for calibrate on single (Switch 3 ON) and automatic calibration must be enabled (Switch 6 ON). These switches must be set prior to powering the unit since they are read-only at power-up.

Automatic calibration provides a time-based trigger that starts the calibration process. Whenever there is no material between the sensing probes for a time equal to or greater than the stored trigger interval (see **Auto-cal Trigger Time** later in this document), the DS1522 enters a wait state in preparation for calibration when material comes between the probes. The display flashes alternately “CA” and blank and the LEDs flash sequentially. The wait for material can be indefinite.

When material enters the gap between the probes, if the calibration delay parameter (**Cd**) is set to zero, calibration occurs within 100 milliseconds. For slow moving material, this delay can be increased (up to 9.9 seconds) to insure the material fully covers the probes before calibration occurs. With no programmed delay, typical calibration time is 300 milliseconds, total. See the **Calibration Delay Time** section later in this document for the parameter adjustment procedure.

If material comes between the probes before the trigger interval times out, the timer is reset to its programmed value.

When automatic calibration is enabled, the calibration process may still be initiated by a press of the CALIBRATE pushbutton or a contact closure between CAL and COM. Actual calibration will begin only when material is sensed between the probes and the calibration delay has timed out.

Multiple Calibration Memories

The DS1522 can store up to 64 calibration settings for later recall. Each calibration is saved in a distinct memory location with an address of 0 through 63. The calibration memory address may be selected through the front panel using the DISPLAY/SELECT pushbutton (local selection) if the GPIO signal on the right side connector is not asserted. If the GPIO signal is asserted, the memory address must be selected through the IN1 through IN5 terminals of the right side connector (remote selection). See **Control Module DISPLAY/SELECT Pushbutton** and **Optional Remote Preset Calibration Selection** sections earlier in this document.

To save a calibration setup to a specific memory location, first set the desired memory address either locally with GPIO not asserted or remotely with GPIO asserted. Then proceed through the

CALIBRATION

normal calibration process as described above. For additional calibrations, select a new address and repeat calibration for the new metal samples.

CAUTION: The locally selected memory address and the remotely selected memory address are independent values and may point to two different memory locations. When GPIO is asserted, the calibration values from the remotely selected memory location will be active. When GPIO is not asserted, the calibration values from the locally selected memory location will be active. If the local address is the same as the remote address, the same calibration values will be selected with GPIO asserted or not asserted.

Auto-cal Trigger Time

The trigger time interval for automatic calibration can be set by the operator through the CALIBRATE pushbutton on the front panel of the DS1522 control unit. The interval is set in increments of 6 seconds (0.1 minutes) from 0 to 3 minutes, in increments of 12 seconds (0.2 minutes) from 3 to 5 minutes, in increments of 30 seconds (0.5 minutes) from 5 to 10 minutes, and in increments of 1 minute from 10 to 25 minutes. To set the trigger time interval, do the following:

1. Insure that the unit is not attempting to calibrate (no “CA” flashing on the digital display). If “CA” is flashing, place a piece of material between the probes and allow the calibration process to be completed. Calibration and time parameter adjustment are mutually exclusive processes.
2. Hold the CALIBRATE pushbutton in for approximately 6 seconds or until “Ct” appears on the digital display. Prior to displaying “Ct”, the DS1522 displays “Ut” followed by “Lt” (for upper tolerance and lower tolerance adjustment). *WARNING: If the pushbutton is released before 3 seconds, the DS1522 begins the calibration process.*
3. When “Ct” displays, release the pushbutton and the trigger time interval is displayed on the digital readout. If the pushbutton is not pressed again within 5 seconds, the display reverts back to displaying gauge signal strength and the current time value is retained.
4. Whenever the time interval is displaying, the pushbutton may be pressed to increment the time to the desired value. The time value is incremented one resolution unit with every press and release of the pushbutton. If the pushbutton is held in, the value auto-increments at an ever increasing rate until the pushbutton is released. The value increments up to a maximum of 25 minutes and then rolls back to 0.1 minutes.
5. When the time has been adjusted to the desired value, it displays for 5 seconds (assuming the pushbutton is not pressed again) and then is accepted and saved in non-volatile memory. The display reverts back to displaying signal strength.

Calibration Delay Time

The “**Cd**” parameter specifies the duration of a time delay that applies to single sample calibration, in both manual and automatic trigger modes. The sequencing is as follows:

1. Calibration is triggered, either manually or through trigger time-out.
2. The system waits indefinitely until metal is detected between the probes.
3. When metal is detected, the calibration delay time-out begins.
4. When the calibration delay has timed out, calibration begins.
5. When calibration is complete, gauging begins.

The calibration delay interval can be set to any value between 0.0 and 9.9 seconds. To set the calibration delay time, proceed as follows:

1. Insure that the unit is not attempting to calibrate (no “**CA**” flashing on the digital display). If “**CA**” is flashing, place a piece of material between the probes and allow the calibration process to be completed. Calibration and time parameter adjustment are mutually exclusive processes.
2. Hold the CALIBRATE pushbutton in for approximately 6 seconds or until “**Cd**” appears on the digital display. Prior to displaying “**Cd**”, the DS1522 displays “**Ut**” followed by “**Lt**” and then, if auto-cal is enabled, by “**Ct**”. *WARNING: If the pushbutton is released before 3 seconds, the DS1522 begins the calibration process.*
3. When “**Cd**” displays, release the pushbutton and the calibration delay time interval is displayed in seconds on the digital readout. If the pushbutton is not pressed again within 5 seconds, the display reverts back to displaying gauge signal strength and the current delay value is retained.
4. Whenever the time interval is displaying, the pushbutton may be pressed to increment the time to the desired value. The time value is incremented one resolution unit with every press and release of the pushbutton. If the pushbutton is held in, the value auto-increments at an ever increasing rate until the pushbutton is released. The value increments up to a maximum of 9.9 seconds and then rolls back to 0.0 seconds.
5. When the time has been adjusted to the desired value, it displays for 5 seconds (assuming the pushbutton is not pressed again) and then is accepted and saved in non-volatile memory. The display reverts back to displaying signal strength.

SPECIFICATIONS

SPECIFICATIONS

Power Requirements

AC Power, 90 to 240 volts, 15 watts.

Logic Input Electrical Specifications

CAL, RESET, AUXIN: 30 Volts maximum
Upper switch threshold - 6.9 volts
Lower switch threshold - 3.3 volts

When the internal jumper is installed for pull up to accommodate sinking drivers, the input is pulled to +15 volts through 4700 ohms. When the jumper is installed for pull down to accommodate sourcing drivers, the input is pulled to common through 4700 ohms.

Logic Output Electrical Specifications

AUXO, FAULT: NPN open collector, 100mA max., 50 volts max.

Output Relay Specifications

Maximum switched voltage: 380VAC
Maximum switched current: 14 amps N.O., 5 amps N.C, AC resistive,
8 amps DC
Maximum switched power: 200W DC, 2,000VA AC.
Minimum required contact load: 12V, 100 mA

Expected mechanical life: 20 million operations
Expected electrical life: 100,000 operations at 8 amps, 240VAC
50,000 operations at 14 amps N.O., 5 amps N.C.,
120VAC resistive
30,000 operations at 7.2FLA, 45LRA, 120VAC
10,000 operations at 5FLA, 30 LRA, 240VAC

Selector Port Electrical Specifications

IN1, IN2, IN3, IN4, IN5, IN6, GPIO

Input resistance: 4,700 ohms
Pullup voltage (jumper set left): 15 volts
Max input voltage: 30 volts
On threshold: 6.9 volts
Off threshold: 5 volts
Response time: 100 microseconds

TROUBLESHOOTING

Should trouble develop, proceed as follows:

1. If no indicators or displays are illuminated, check AC input power to the control module and the fuse located on the lower left of the chassis.
2. If the unit powers up but hangs displaying alternately “**Pr**” and “**01**”, the transmitter probe is either not connected, is shorted, or has an open in the wiring.
3. If the unit powers up, initializes and the LEDs indicate a response to the material in the gap but the relays do not switch, check that the relays are set to follow and not to latch (activate the RESET input to unlatch). For most installations, simply install jumpers between RESET and COM.
4. IF “**PR**” and “**01**” flash alternately on the display, check the transmitting probe for proper connection and continuity.
5. IF “**PR**” and “**02**” flash alternately on the display, check the receiving probe for proper connection and continuity.
6. IF “**PR**” and “**03**” flash alternately on the display, check both probes for proper connection and continuity.
7. If the DS1522 hangs displaying alternately “**gAP**” and “**CA**”, the control module has determined that the gap has not been calibrated. Remove all material from between the probes then press and hold the CALIBRATE GAP pushbutton for a minimum of three seconds (until the unit begins displaying alternately **gAP** and **SU**).
8. If the DS1522 hangs displaying alternately **SL** and **Er**, an invalid preset calibration address is being applied to the external preset select port.
9. If the unit flashes alternately “**Er**” and a numeric value between 1 and 5, perform the corrective action prescribed in the table below. If the error persists, consult the factory.

<u>“Er” Number</u>	<u>Fault Description</u>	<u>Correction</u>
01	PSD RAM failure	Reset through power down
02	Display shift register failure	Reset through power down
03	Input shift register failure	Reset through power down
04	Control shift register failure	Reset through power down
05	Digital synthesizer failure	Reset through power down
08	ystem configuration data fault	Reset through power down

10. During manual calibration on single and double, errors may occur that are reported through the alternate display of “**CE**” and a numeric value of 1 or 2. These error codes have the following meanings:

<u>“CE” Number</u>	<u>Interpretation</u>
01	The single thickness material is too thin for the system as configure with the current probes.
02	The material is too thick for the system as configured with the current probes.

11. After calibration the LEDs on the DS1522 flicker between NOMINAL and OVER or between NOMINAL and UNDER or between all three. Usually this indicates that the

TROUBLESHOOTING

tolerances are too tight. Adjust the tolerances through the CAL pushbutton as described earlier in this document under Gauge Tolerance Adjustment in the SETUP section.

Firmware Version

From time to time, as improvements are made to Prime products, the firmware controlling the units is revised. When setting a unit up or troubleshooting it may be necessary to determine the version number for the firmware installed in your unit. The version numbers begin with 1.0 and are incremented either by tenths (1.1, 1.2, etc.) for small revisions or by the integer digit (1.0, 2.0, etc.) for more significant revisions.

To determine the version of the firmware running in your unit, simply hold the calibration pushbutton in as power is applied to the unit. The revision number will be displayed on the two-digit display alternately with the letters “Fr”. For example, Version 1.8 will flash alternately “Fr” and “1.8”.

For further information or service assistance, contact Prime Controls, Inc., 4551 Gateway Circle, Dayton, Ohio. Phone: (937) 435-8659. Mention model number and serial number.

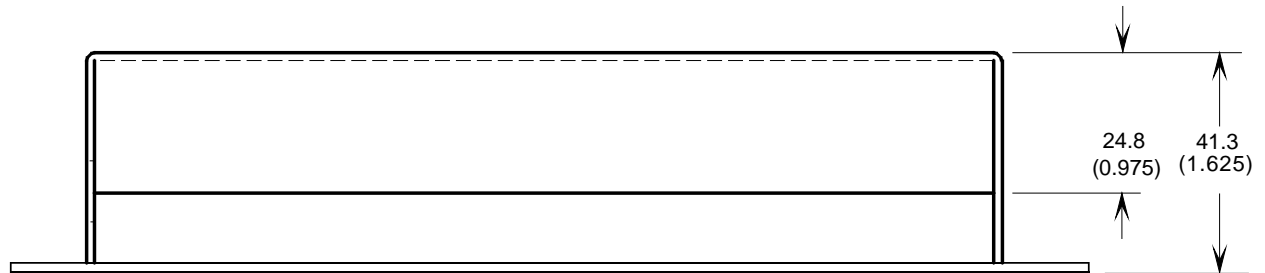
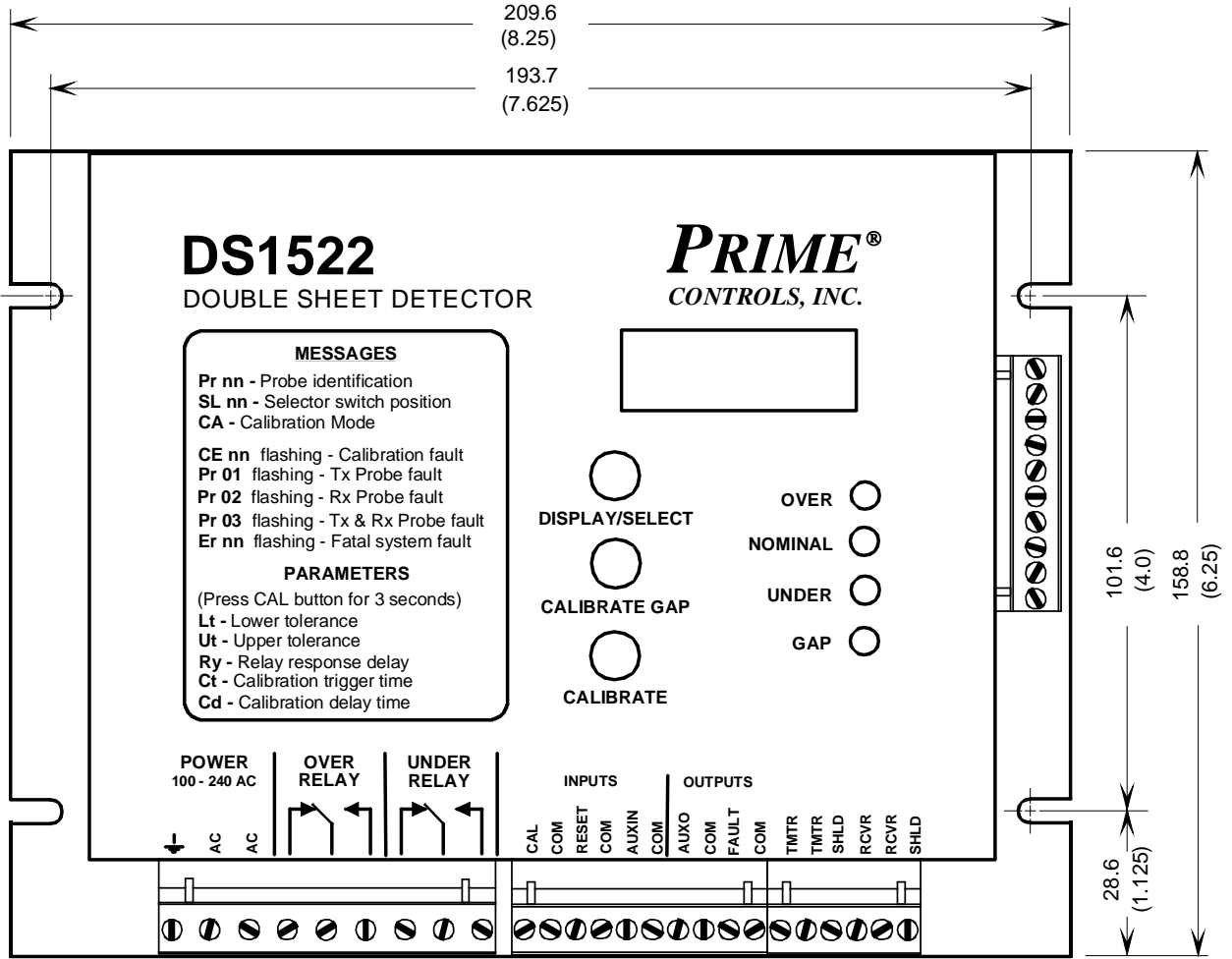

DS1522

DOUBLE SHEET DETECTOR

PRIME[®]
CONTROLS, INC.

MESSAGES

Pr nn - Probe identification
 SL nn - Selector switch position
 CA - Calibration Mode

CE nn flashing - Calibration fault
 Pr 01 flashing - Tx Probe fault
 Pr 02 flashing - Rx Probe fault
 Pr 03 flashing - Tx & Rx Probe fault
 Er nn flashing - Fatal system fault

PARAMETERS

(Press CAL button for 3 seconds)

Lt - Lower tolerance
 Ut - Upper tolerance
 Ry - Relay response delay
 Ct - Calibration trigger time
 Cd - Calibration delay time

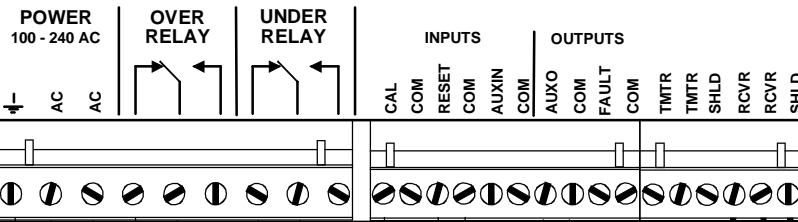
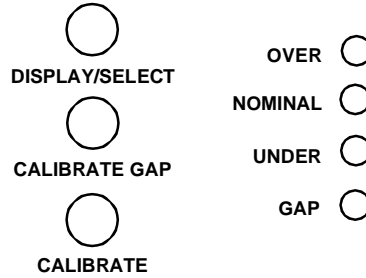

SAFETY GND

AC POWER

CONTROL INTERLOCK
OPEN FOR DOUBLE

CONTROL INTERLOCK
OPEN FOR UNDER
OPTIONAL

REMOTE CAL
OPTIONAL

OUTPUT LATCH RESET
JUMPER SOLID IF LATCHING
OUTPUT NOT DESIRED

TO PROBES

FAULT SIGNAL
NPN, OPEN COLLECTOR
100 mA MAX., OFF = FAULT
HOOKUP IS OPTIONAL

FAST RESPONSE OUTPUT
NPN, OPEN COLLECTOR, 100 mA MAX.
OFF FOR OVER OR UNDER, NO DELAY.
NOT AVAILABLE IF SM10 SWITCH
MODULE OPTION IS INSTALLED.

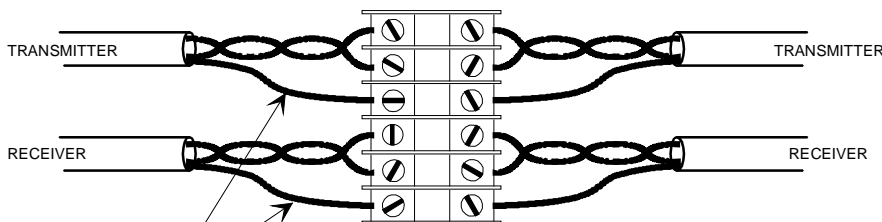

3. MAINTAIN INDEPENDENT SHIELDS
4. POSITION SHIELD TERMINALS BETWEEN TRANSMITTER AND RECEIVER SIGNAL TERMINALS

FOR MAXIMUM NOISE IMMUNITY, SPLICE OR TERMINATE CABLES ONLY WHEN ABSOLUTELY NECESSARY.

WHERE EXTENSION IS NECESSARY, USE BELDEN 8761 OR EQUIVALENT SHIELDED, TWISTED PAIR CABLE.

THE DS1520 IS DESIGNED TO PROVIDE HIGH COMMON MODE NOISE REJECTION. COMMON MODE REJECTION IS REALIZED MOST EFFECTIVELY WITH TWISTED PAIR CABLING.

LIMITATION AND EXCLUSION OF WARRANTIES

All goods purchased from Prime Controls, Inc. shall be free from defects in materials, design and workmanship under normal conditions of use for one year from the date of shipment. THIS WARRANTY IS THE SOLE WARRANTY AND IS EXPRESSLY IN LIEU OF ALL OTHER WARRANTIES, EXPRESSED OR IMPLIED, INCLUDING BUT NOT LIMITED TO ANY IMPLIED WARRANTY OF MERCHANTABILITY OF FITNESS FOR A PARTICULAR PURPOSE. THE LIABILITY OF PRIME CONTROLS TO ANY PURCHASER SHALL BE LIMITED EXCLUSIVELY TO THE COST OF REPLACEMENT OR REPAIR OF DEFECTIVE PARTS, AND SHALL NOT INCLUDE LIABILITY FOR ANY DIRECT, CONSEQUENTIAL OR INCIDENTAL DAMAGES WHATSOEVER, WHETHER FORESEEN OR UNFORESEEN, INCLUDING BUT NOT LIMITED TO LOST PROFITS, LOST SALES, OR INJURY TO PERSONS OR PROPERTY. 12/14/21

Revision	Date	Description	Author
A	2007-08-07	Initial Release	
B	2020-05-27	Updates and Clarifications	
C	2021-12-14	Explained Outputs in regard to DIP switch 8	